

⚠ Before installation, wiring, operation, maintenance and inspection of the device, be sure to read the operating instructions carefully to ensure proper operations.

1. Ratings

Type	GMCBU		
Rated Current	1,2,3,4,5,6,8,10,15,16,20,25,30,32,40,50,63A		
Rated Voltage	(1~63A, AC)	(1~25A, AC)	(1~63A, DC)
	1P: 120/240V	1P: 277V	1P: 60V
	2P: 240V 3P: 240V	2P: 480Y/277V 3P: 480Y/277V	2P: 125V 3P: 125V
Breaking Capacity	10,000A		
Characteristics	B, C, D		
Mount	On 35mm DIN-Rail Mounting angle 90°		
Terminal Wire Capacity	Lug Type (14 to 4 AWG)		
Aux. Contact/Alarm	GMCBU-AUX11, GMCBU-ALM11		
Shunt Trip/Under voltage trip	GMCBU-SH, GMCBU-UV		
Enclosure size	≥200(W) × 300(L) × 97(H)mm		
Normal Ambient Temperature	-5 to 40°C		

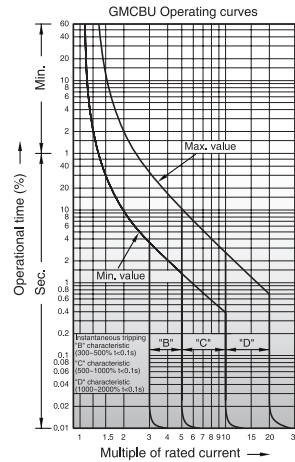

2. Installation

1) Installation and Removal

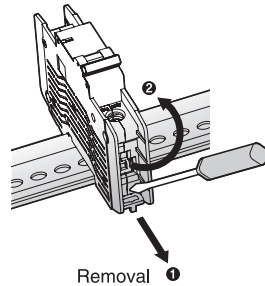
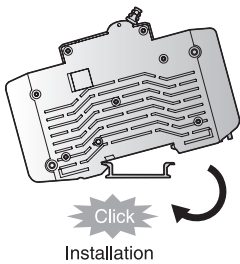

2) Connection

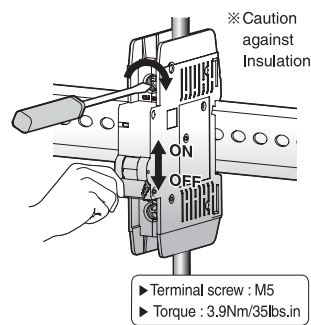

In	Max. Wiring Capacity (Use copper wire rated for 65°C)
1~15A	14AWG
16~20A	12AWG
21~30A	10AWG
31~40A	8AWG
50A	6AWG
63A	4AWG

Reference: UL 489

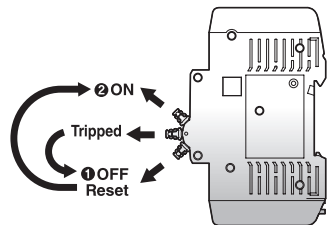

Attention:
When the handle is in TRIPPED position,
1) Push it down to the OFF position
2) Push it to the ON position

3. Safety Precaution

- ⚠ **DANGER:** Not following instructions could result in death or serious injury.
- ⚠ **CAUTION:** Not following instructions could result in minor injury or physical damage.

⚠ DANGER

- 1) Turn off the upstream circuit breaker before installing or service to prevent electric shocks and burns due to short circuit.
- 2) Do not touch any live naked terminals. It makes an electric shock.
- 3) Do not touch two live lines simultaneously. The circuit breaker does not operate even if an electric shock occurs.

⚠ CAUTION

- 1) Installation by qualified electrician only, per NEC.
- 2) Do not install the circuit breaker in place of environment with shock, high temperature, humidity, dust, corrosive gases, excessive vibration, etc. to prevent fire accidents and malfunction of the device.
- 3) Use the breaker in a range of the rated voltage and current shown on the name plate. Or it may cause malfunction.

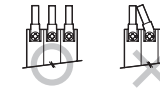

- 4) Each terminal or conductor pole should be connected in parallel as shown below.
- 5) Be sure to ground the ground terminals of electrical devices.
- 6) When the circuit breaker trips, remove the fault and turn the handle "ON". Or else, it may lead to the fire accident.
- 7) Do not modify the device unless it is permitted.
- 8) When the device become useless, it should be dispose of them as an industrial waste.
- 9) In order to fix MCB in DIN-Rail, Install end bracket on the both MCB side, After wiring.

4. Dimension

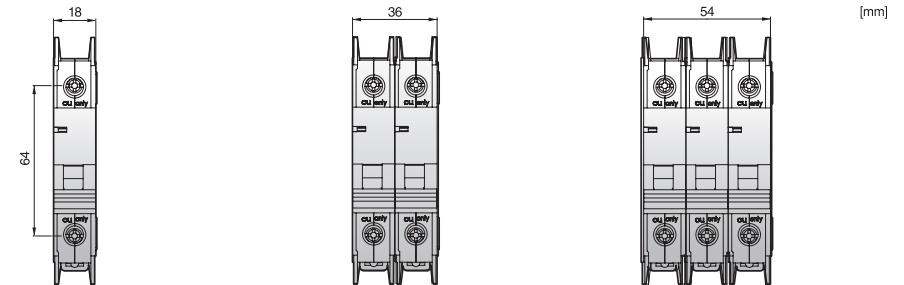

*Each item's appearance varies slightly.
But Terminal height and Overall dimension are same

Acceptable fork terminal

